

PLAN OF LAND ACQUIRED PERMANENTLY FOR INSPECTION ROAD OF B.N.M.C. OF
(LEFT BANK) IN CONNECTION WITH M.R.P. IN MOUZA-SENDAZAMUAR J.L.NO.
106. P.S. RAGHUNATHGANJ. DT. MUSHIDABAD.

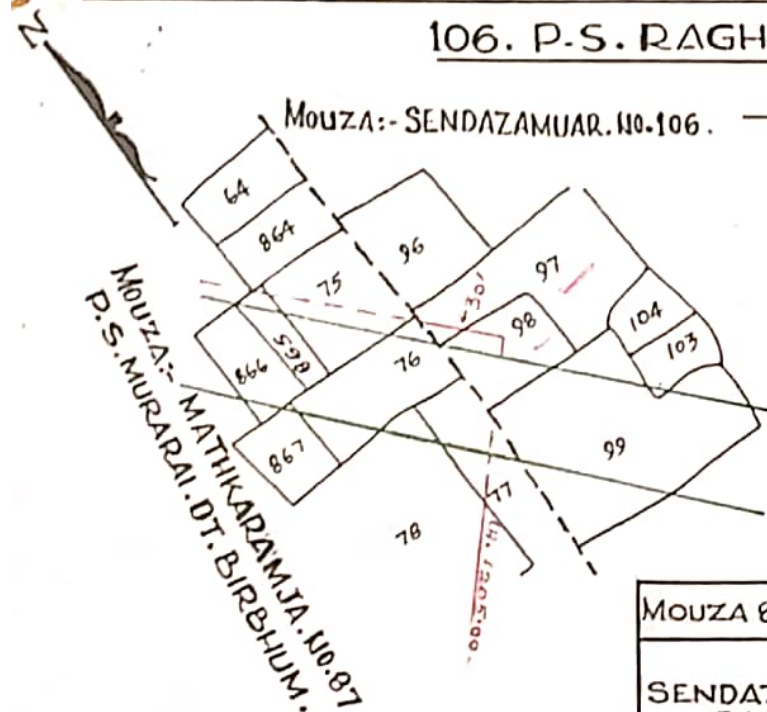

SCALE:- 330' = 1"

REF:-

LAND ALREADY ACQUIRED SHOWN THUS.. ———

LAND ACQUIRED PERMANENTLY SHOWN THUS. ———

SCHEDULE OF LANDS.

MOUZA & J.L.NO.	P. S.	DIST.	C.S. PLOTS	AREA
SENDAZAMUAR J.L. NO. 106.	RAGHUNATH -GANJ.	MURSHI- -DABAD.	97, 98 IN PART.	09 00 3/4 acre.

CERTIFIED THAT THE LANDS IN THIS PLAN WERE DULY ACQUIRED UNDER THE PROVISIONS OF THE WEST BENGAL LAND (REQUISITION & ACQUISITION) ACT-II OF 1948 & UNDER NOTICE NO. 15214 L.A.(RW.) DATED THE 15TH SEPT, 67 AND PUBLISHED AT PAGE 2750 PART-I OF THE CAL. GAZETTE OF THE 14TH DEC, 67 & IN PROCEEDINGS NO. 86 A OF 1962-63 & THAT UNDER SEC. 4(1A) OF THE ACT. THEY HAVE VESTED ABSOLUTELY IN THE J & W. DEPT. OF THE STATE GOVT. FROM THE 14TH DEC, 1967.

PREPARED By: *[Signature]*
 27/11/70
 (KD. BY: *[Signature]*)

SPL. L.A. OFFICER,
 BIRBHUM.

ADDL. DIST. MAGISTRATE,
 BIRBHUM.

MOUZA:- SENDEZAMUYAR. T.L. 106.
P.S. RAGHUNATHGANJ.
DT. MURSIDABAD.

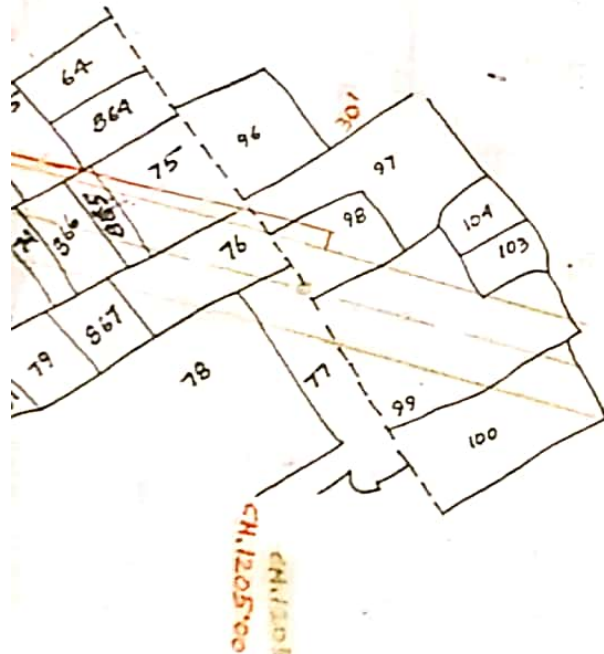

MOUZA:- MATHKARAMTA. T.L. 87.
P.S. MURARAI.
DT. BIRBHUM.

<u>MAYURAKSHI PROJECT.</u>		
<u>LAND PLAN SHOWING THE ADDL. LAND</u>		
<u>TO BE ACQUIRED PERMANENTLY FOR INS-</u>		
<u>PECTION ROAD FROM CH. 1164.00 TO CH.</u>		
<u>1205 OF B.N.M.C. (LT. BANK.)</u>		
<u>DRG. NO.</u>		<u>SCALE: 330' = 1"</u>
<u>TRACED BY</u>		
<i>R. Barmora</i> 13.2.63.		<i>Amph</i>
<u>CHECKED BY</u>		
<i>M. N. C. DN.</i> 13.2.63	<u>S. D. O.</u> NALHATI IRRGN SUB- -DVN	<u>E. E.</u> <u>M. N. C. DN.</u>

REFERENCE.

1. LAND ALREADY ACQUIRED PERMANENTLY VIDE S.A.
L.A.O'S NO. 2877/LA. DT. 16.12.53 (R.A. CASE. 109 OF 52-53 ...)
2. LAND TO BE ACQUIRED SHOWN THIS ...